

A11515752 © Miami MLS® 2024

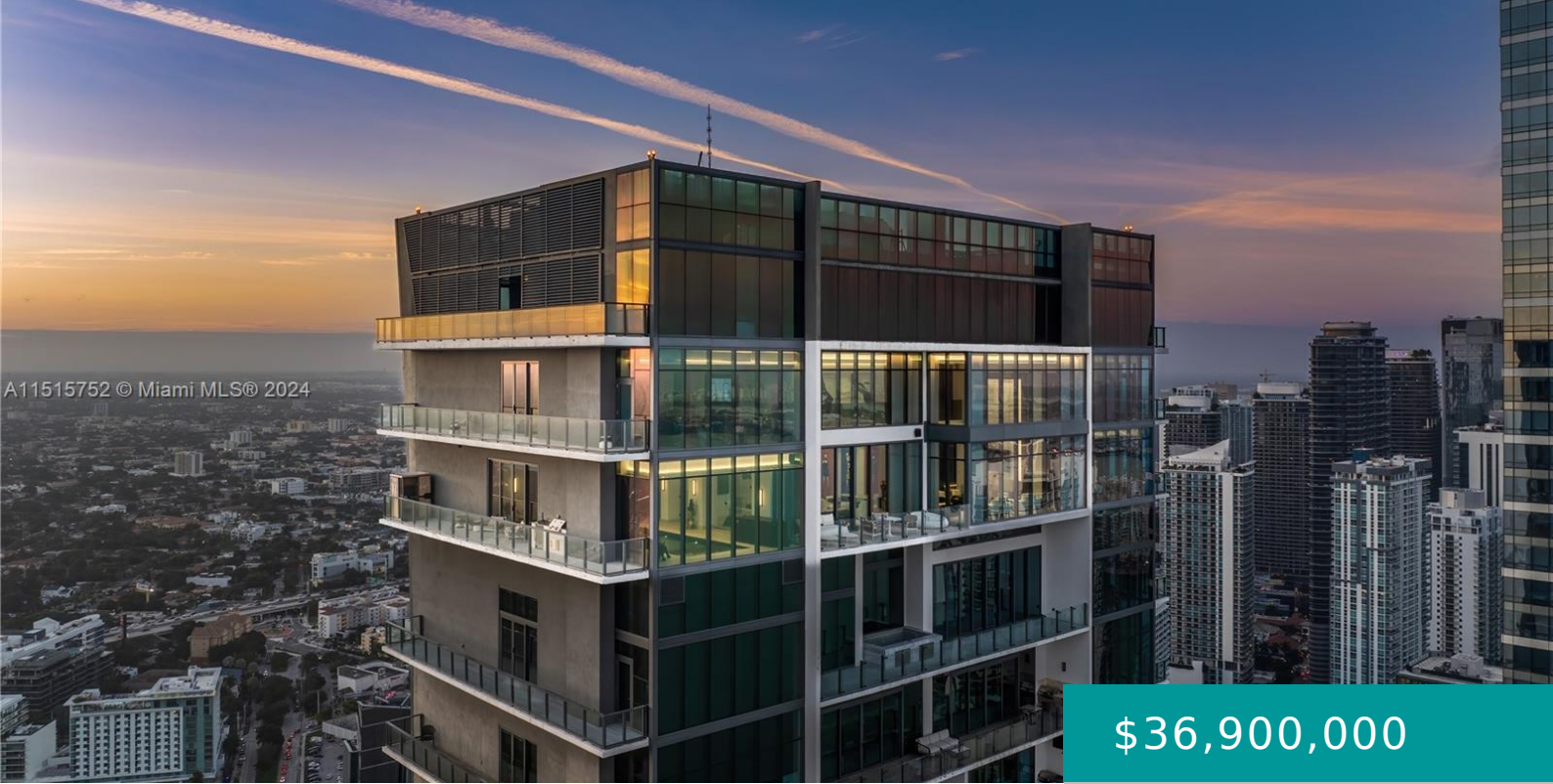

\$36,900,000

1451 BRICKELL AVE PH56 MIAMI FL 33131

<https://miamirealestateinc.com>

Penthouse living like you've never seen it before at the prestigious Echo Brickell Condominium. Boasting two stories and an expansive 11,000+ square feet of opulent living space with 28 ft. ceilings, 360-degree captivating views, and your very own indoor sky pool, this elegant fully furnished residence features 5 bedrooms, 7.5 custom marble bathrooms, a Poliform [...]

- 5 beds
- 8 baths
- Condominium
- Residential
- Active
- 11068 sq ft

Basics

Bathrooms Half: 1

Lot Size Units: Square Feet

Type: Condominium

Bedrooms: 5 beds

Area: 11068 sq ft

Bathrooms Full: 7

Category: Residential

Status: Active

Bathrooms: 8 baths

Year built: 2017



Rooms & Units Description

Unit Number: PH56

Location Details

County Or Parish: Miami-Dade County

Property details

Total Building Area: 11068

Parcel Number: 01-41-39-128-1790

Subdivision Name: ECHO BRICKELL CONDO

Possession: Closing & Funding

Property Features



Exterior Features:

Balcony,Barbecue,Security/High Impact Doors

Accessibility Features: Accessible Elevator Installed

Window Features: Blinds,Impact Glass

Parking Features: Attached,Garage,Two or More Spaces

Appliances: Dryer,Dishwasher,Washer

Association Amenities: Cabana,Fitness Center,Pool,Sauna,Spa/Hot Tub,Elevator(s)

Cooling: Central Air

Covered Spaces: 6

Flooring: Wood

Garage Spaces: 6

Heating: Central

Pets Allowed: Conditional,Yes

View Y/N: 1

Entry Location: 56

Property Attached Y/N: 1

Attached Garage Y/N: 1

Interior Features: Built-in Features,Bedroom on Main Level,Dining Area,Separate/Formal Dining Room,Second Floor Entry,Entrance Foyer,First Floor Entry,Fireplace,Kitchen Island,Kitchen/Dining Combo,Upper Level Primary,Bar,Walk-In Closet(s),Elevator

Waterfront Features: Bay Front

Pool Features: Association

Security Features: Door Man,Elevator Secured

Architectural Style: High Rise

Construction Materials: Block

Cooling Y/N: 1

Fireplace Y/N: 1

Furnished: Furnished

Garage Y/N: 1

Heating Y/N: 1

View: Bay,Ocean

Entry Level: 56

Patio and Porch Features: Balcony,Open

Waterfront Y/N: 1

Stories Total: 57

Miscellaneous

Public Survey Township: 1

Public Survey Section: 39

Syndication Remarks: Located in the heart of the financial district, this bayfront gem redefines luxury living.

Year Built Details:
Resale

Virtual Tour URL:

<https://www.propertypanorama.com/instaview/mia/A11515752>



Fees & Taxes

Tax Annual Amount: 175146

Tax Year: 2023

Tax Legal Description: ECHO BRICKELL
CONDO UNIT PH56 UNDIV 3.306% INT IN
COMMON ELEMENTS OFF REC 28880-4047

Association Fee: 17812

Association Fee Frequency: Monthly

Association Fee Includes: Amenities, Common
Areas, Maintenance Structure, Pool(s), Recreation
Facilities, Sewer, Water

Courtesy of

Office Name: Compass Florida, LLC

