

DEVELOPED BY
FORTUNE INTERNATIONAL

CREATED BY
HERZOG & DE MEURON

INTERIOR ARCHITECTURE
PYR LED BY PIERRE-YVES ROCHON

A11319075 © Miami MLS® 2023

SIGNATURE RESIDENCE MODEL A2S

LINE 01

BUILDING ZONE ZONE B
FLOORS 26-34

RESIDENCE DESCRIPTION

4 BED/5.5 BATH + FAMILY + MEDIA + SERVICE
QUARTERS
INTERIOR 3,396 SQ FT 316 SQM
OUTDOOR LIVING 909 SQ FT 84 SQM
TOTAL 4,305 SQ FT 400 SQM

JADESIGNATURE.COM

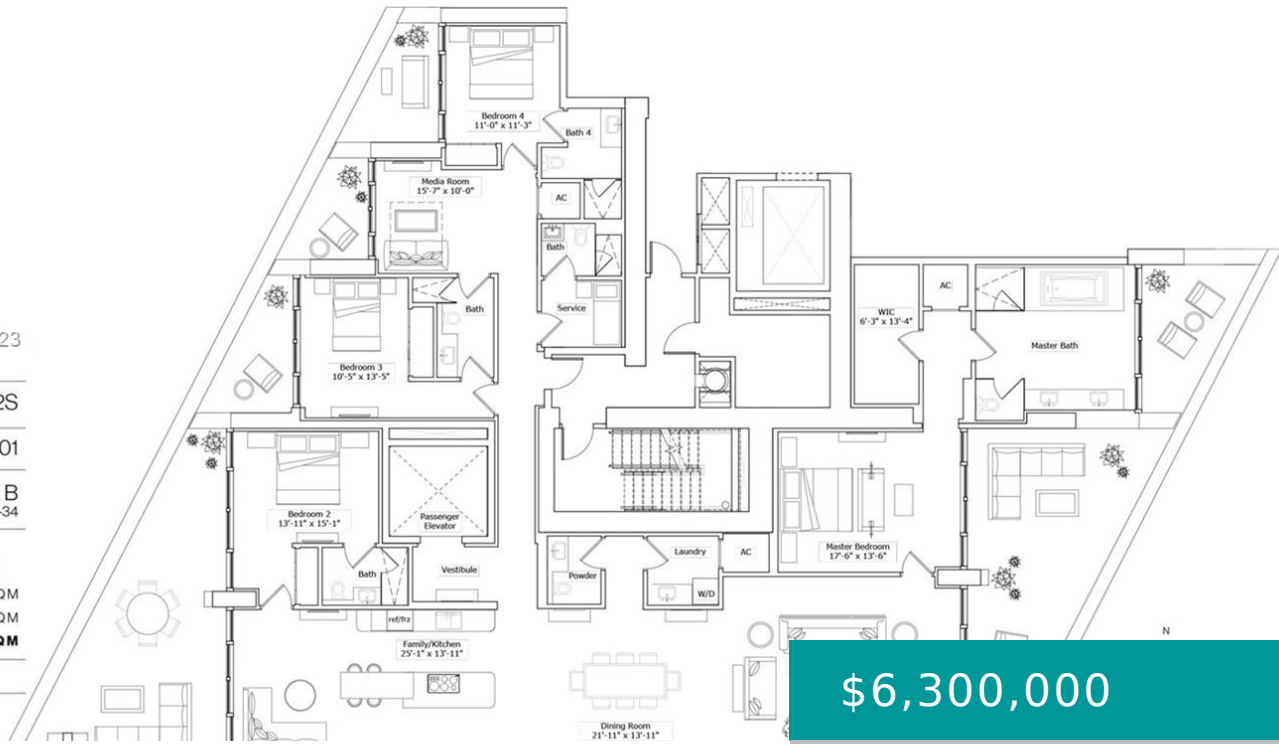

\$6,300,000

- 5 beds
- 6 baths
- Condominium
- Residential
- Active
- 3012 sq ft

16901 COLLINS AVE 3401 MIAMI FL 33160

<https://miamirealestateinc.com>

3,396 soft living area plus 909 sqft outdoor, total 4,305 square feet. The unit is being offered fully professionally decorated and furnished. 5 bedrooms + maid's Quarters with stunning marble floors, automated curtains, finished closets. Balcony on each and every room. Designed by renowned architect, Herzog and de Meuron, Jade Signature is a work of art. [...]

Basics

Bathrooms Half: 1

Lot Size Units: Square Feet

Type: Condominium

Bedrooms: 5 beds

Area: 3012 sq ft

Bathrooms Full: 5

Category: Residential

Status: Active

Bathrooms: 6 baths

Year built: 2018



Rooms & Units Description

Unit Number: 3401

Location Details

County Or Parish: Miami-Dade
County

Directions: Collins Ave. (A1A) to 16901 Collins Ave. (ocean side). Valet on 2nd level.

Property details

Total Building Area: 3012

Direction Faces: East

Subdivision Name: JADE SIGNATURE CONDO

Parcel Number: 31-22-11-076-0290

Possession: Closing & Funding

Property Features



Exterior Features:
Security/High Impact
Doors

Waterfront Features:
Ocean Access,Ocean Front

Pool Features:
Association,Heated

Security Features:
Smoke Detector(s)

Architectural Style: High
Rise

Construction Materials:
Block

Cooling Y/N: 1

Flooring: Marble,Wood

Garage Spaces: 2

Heating: Central,Electric

Pets Allowed: Dogs
OK,Yes

View Y/N: 1

Entry Location: 34

Waterfront Y/N: 1

Utilities: Cable Available

Interior Features: Bidet,Built-in Features,Breakfast Area,Closet
Cabinetry,Dining Area,Separate/Formal Dining Room,Dual Sinks,Eat-
in Kitchen,High Ceilings,Jetted Tub,Kitchen Island,Other,Separate
Shower,Walk-In Closet(s)

Window Features: Blinds,Impact Glass

Parking Features: Two or More Spaces

Appliances: Dryer,Dishwasher,Electric Range,Electric Water
Heater,Disposal,Microwave,Refrigerator,Trash Compactor,Washer

Association Amenities: Business
Center,Cabana,Clubhouse,Community Kitchen,Fitness
Center,Playground,Pool,Sauna,Trail(s),Trash,Elevator(s)

Cooling: Central Air,Electric

Covered Spaces: 2

Furnished: Furnished

Garage Y/N: 1

Heating Y/N: 1

View: Intercoastal,Ocean

Entry Level: 34

Property Attached Y/N: 1

Stories Total: 57

Miscellaneous

Public Survey Township: 31

Syndication Remarks: 3,396 soft living area plus 909 sqft outdoor, total
4,305 square feet. The unit is being offered fully professionally decorated and
furnished

Virtual Tour URL:

<https://www.propertypanorama.com/instaview/mia/A11319075>

**Public Survey
Section:** 11

**Year Built
Details:** New
Construction



Fees & Taxes

Tax Annual Amount: 5542

Tax Year: 2022

Tax Legal Description: JADE SIGNATURE CONDO UNIT 3401 UNDIV
0.55343% INT IN COMMON ELEMENTS OFF REC 28817-3997

**Association Fee
Frequency:**
Monthly

Association Fee Includes: Association Management,Amenities,Common
Areas,Hot Water,Insurance,Maintenance Grounds,Maintenance
Structure,Parking,Pool(s),Recreation Facilities,Sewer,Security,Trash,Water

Courtesy of

Office Name: FACCIN Group Realty

